

- Phase 1 Site Boundary
- 1km Study Area
- HER Monument Records
- HER Events
- NMP Records

client	Bloor Homes Ltd		
project title	Land at South Farm, Wickwar, South Gloucestershire		
drawing title	Plan EDP 2: HER records		
date	16 SEPTEMBER 2021	drawn by	MH
drawing number	edp6190_d009b	checked	RS
scale	1:12,000 @ A3	QA	RB



**Plan EDP 3**  
**Extract from 1838 Tithe Map of Wickwar Parish**  
(edp6190\_d010b 01 December 2021 MH/RS)





 Approximate Phase 1 Site Boundary

client			
Bloor Homes Ltd			
project title			
Land at South Farm, Wickwar, South Gloucestershire			
drawing title			
Plan EDP 3: Extract from 1838 Tithe Map of Wickwar Parish			
date	01 DECEMBER 2021	drawn by	MH
drawing number	edp6190_d010b	checked	RS
scale	1:4,000 @ A3	QA	RB



**Plan EDP 4**  
**Extract from 1882 First Edition Ordnance Survey Map**  
(edp6190\_d011b 01 December 2021 MH/RS)



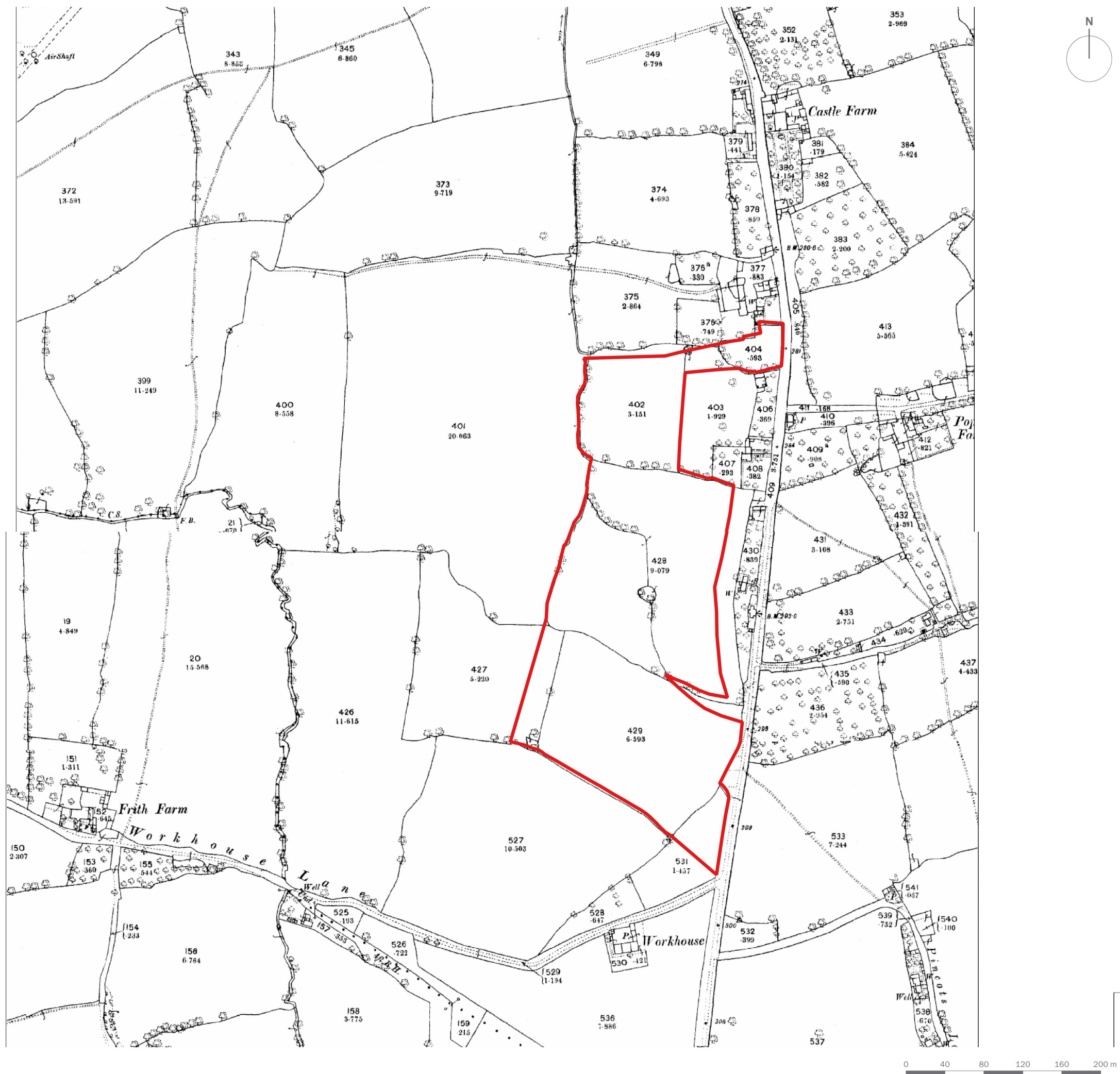

 Approximate Phase 1 Site Boundary

client

**Bloor Homes Ltd**

project title

**Land at South Farm, Wickwar, South Gloucestershire**

drawing title

**Plan EDP 4: Extract from 1882 First Edition Ordnance Survey Map**

date	01DECEMBER 2021	drawn by	MH
drawing number	edp6190_d011b	checked	RS
scale	1:4,000 @ A3	QA	RB

 the environmental dimension partnership

Registered office: 01285 740427 - [www.edp-uk.co.uk](http://www.edp-uk.co.uk) - [info@edp-uk.co.uk](mailto:info@edp-uk.co.uk)





**CARDIFF**  
**02921 671900**

**CHELTENHAM**  
**01242 903110**

**CIRENCESTER**  
**01285 740427**

**info@edp-uk.co.uk**  
**www.edp-uk.co.uk**

The Environmental Dimension Partnership Ltd. Registered as a Limited Company in England and Wales. Company No. 09102431. Registered Office: Tithe Barn, Barnsley Park Estate, Barnsley, Cirencester, Gloucestershire GL7 5EG



**URBAN  
DESIGN  
GROUP** REGISTERED PRACTICE

**IEMA** Transforming the world to sustainability

**Landscape  
Institute**  
Registered practice